



**5/38-40 Chapman Street Gymea NSW**

2 1 1

Conveniently placed in the heart of Gymea and located on the top floor, this property presents itself as an ideal opportunity for both first-time homeowners and savvy investors. Nestled within a security complex and surrounded by established gardens, this property is just moments away from Gymea shops, café's and transport.

**Type** : Apartment  
**Price** : \$ 770,000  
**View** : <https://www.jreproperty.com.au/sale/nsw/sutherland/gymea/residential/apartment/8476931>

- ? Combined lounge and dining area with split system AC
- ? Updated kitchen with gas cooking
- ? 2 bedrooms, both with built-in wardrobes
- ? Private balcony, west-facing, capturing the afternoon sun
- ? Internal laundry, security complex, conveniently located.
- ? Single lock-up garage with additional storage area



**Luke Jeffree**  
02 9540 2222



**Belinda Sanders**  
02 9540 2222

Strata \$1009.35 pq | Council \$400.00 pq  
[For full version visit the website](https://www.jreproperty.com.au)

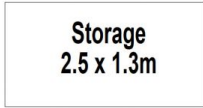

Storage  
2.5 x 1.3m

**BASEMENT**

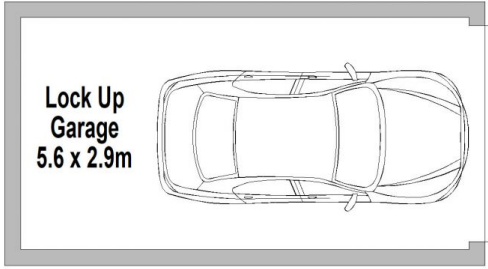

Lock Up  
Garage  
5.6 x 2.9m

**BASEMENT**

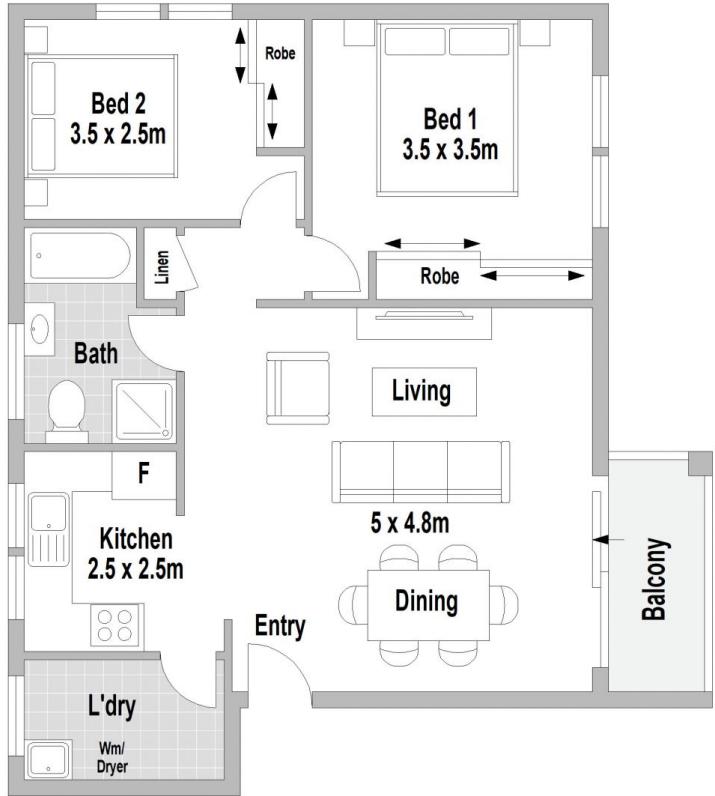

**TOP FLOOR**



**5/36-38 Chapman Street, Gymea**

Scale in metres. Indicative only. Dimensions are approximate. All information contained herein is gathered from sources we believe to be reliable. However we cannot guarantee its accuracy and interested persons should rely on their own enquiries.