



19 Barraran Street Gymea Bay NSW

4 2 2

Nestled in a sought-after cul-de-sac location in Gymea Bay, this much-loved family home presents an exceptional buying opportunity. Set on a generous 720.8sqm block with a 21.64m frontage, the property offers outstanding potential for future growth and development (STCA).

Immaculately maintained and enjoying a sunny west-facing aspect, the home is ready to move into while also offering a blank canvas for future renovations or rebuilds. Its prime location places you close to quality schools, parks, and all family-friendly amenities, making it an ideal choice for those seeking lifestyle and long-term value.

? Multiple choices of spacious formal & casual living and dining areas

[For full version visit the website](https://www.jreproperty.com.au)

Type : House
Land Size : 720.8 sqm
View : <https://www.jreproperty.com.au/sale/nsw/sutherland/gymea-bay/residential/house/8408248>



Luke Jeffree
02 9540 2222



Belinda Sanders
02 9540 2222

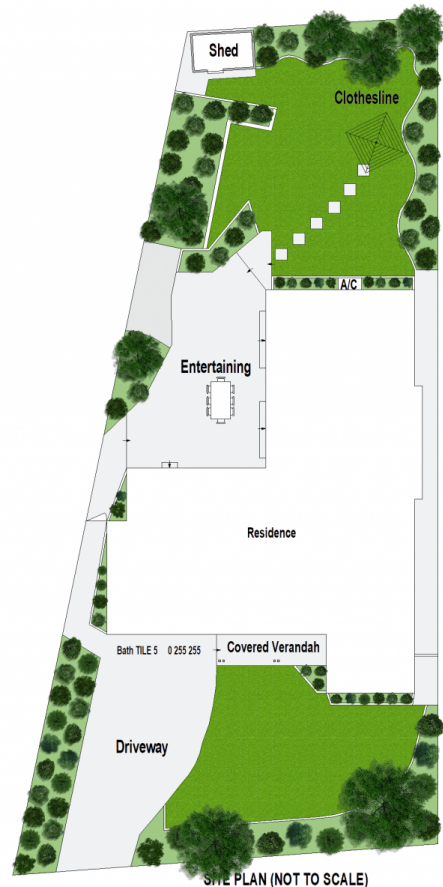
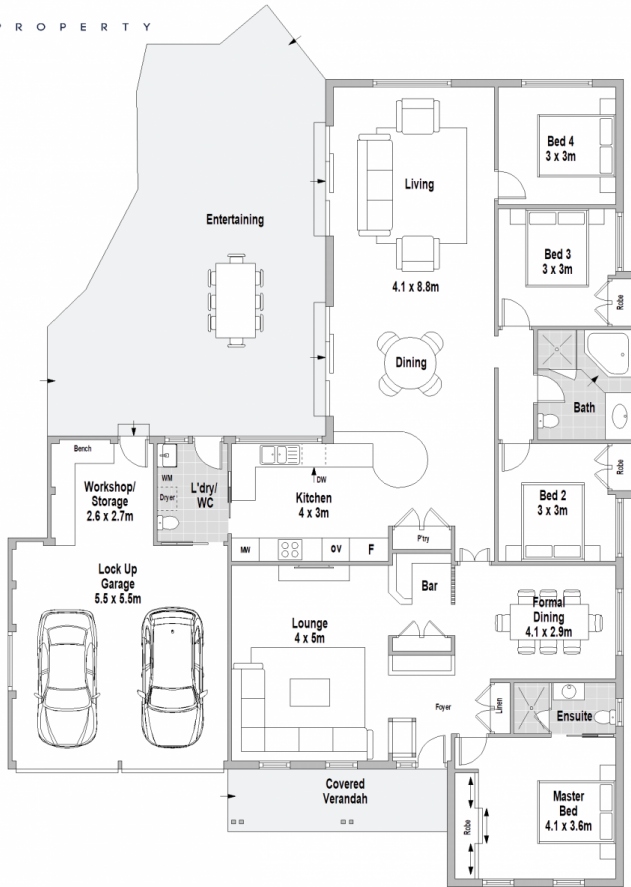

SITE PLAN (NOT TO SCALE)

19 Barraran Street, Gymea Bay



Scale in metres. Indicative only. Dimensions are approximate. All information contained herein is gathered from sources we believe to be reliable. However we cannot guarantee its accuracy and interested persons should rely on their own enquiries.