



4 Peter Place GYMEA BAY NSW

4 3 2

As you walk along the paved pathway through the manicured gardens that lead to the front door, you immediately feel this home has been well cared for. Hidden away in a peaceful tree lined cul-de-sac and adjoining Coonong Creek Reserve this lived in and loved family home is reluctantly offered for sale, offering a rare opportunity in a prime enclave.

Type : House
Land Size : 556.4 sqm
View : <https://www.jreproperty.com.au/sale/nsw/sutherland/gymea-bay/residential/house/7488750>

Privacy and tranquility assured adjoining leafy sub-tropical setting. This immaculate residence offers a relaxed and comfortable lifestyle with modern kitchen, large formal lounge, rumpus room, covered alfresco entertaining area and a large in ground pool with glass fencing and sun drenched deck.

[For full version visit the website](#)

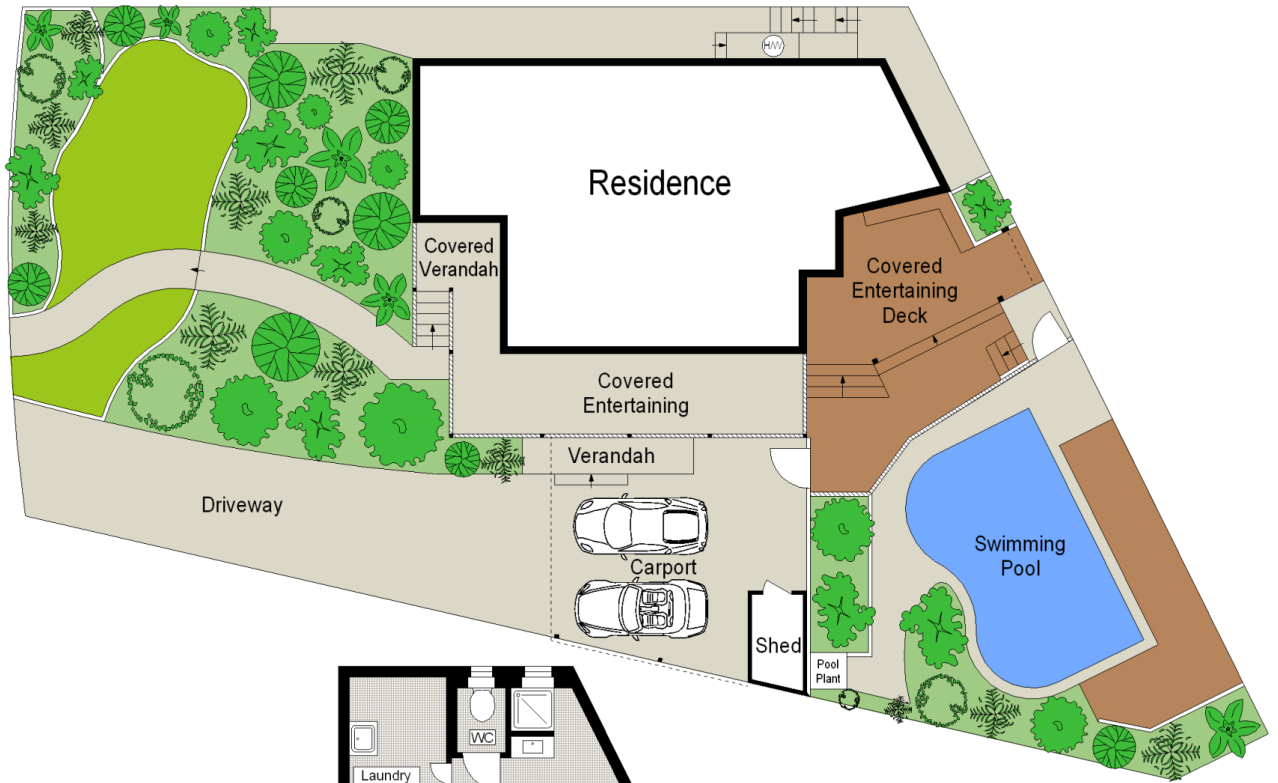

SITE PLAN (NOT TO SCALE)



LOWER GROUND FLOOR

GROUND FLOOR

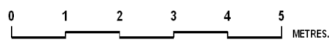

Scale in metres. Indicative only. Dimensions are approximate. All information contained herein is gathered from sources we believe to be reliable. However we cannot guarantee its accuracy and interested persons should rely on their own enquiries.

