



**155 Kiora Road MIRANDA NSW**

4 2 1

Set behind a neat and tidy weatherboard facade, this home will surprise with its generosity of space and family friendly rear yard with level grassed areas and a pool. With a focus on easy-care living and convenience, it provides a free-flowing single level floor plan and ideal setting walking distance to Westfield Miranda and the rail.

**Type** : House  
**Land Size** : 562.8 sqm  
**View** : <https://www.jreproperty.com.au/sale/nsw/sutherlandland/miranda/residential/house/7488566>

Timber floors, open plan living & dining  
 Large family-sized kitchen with servery  
 Generous covered terrace by the pool  
 Four spacious bedrooms, some BIRs  
 Laundry/powder, garden shed, carport  
 Reverse cycle air, enjoy or further update



**Dion Moon**  
02 9540 2222

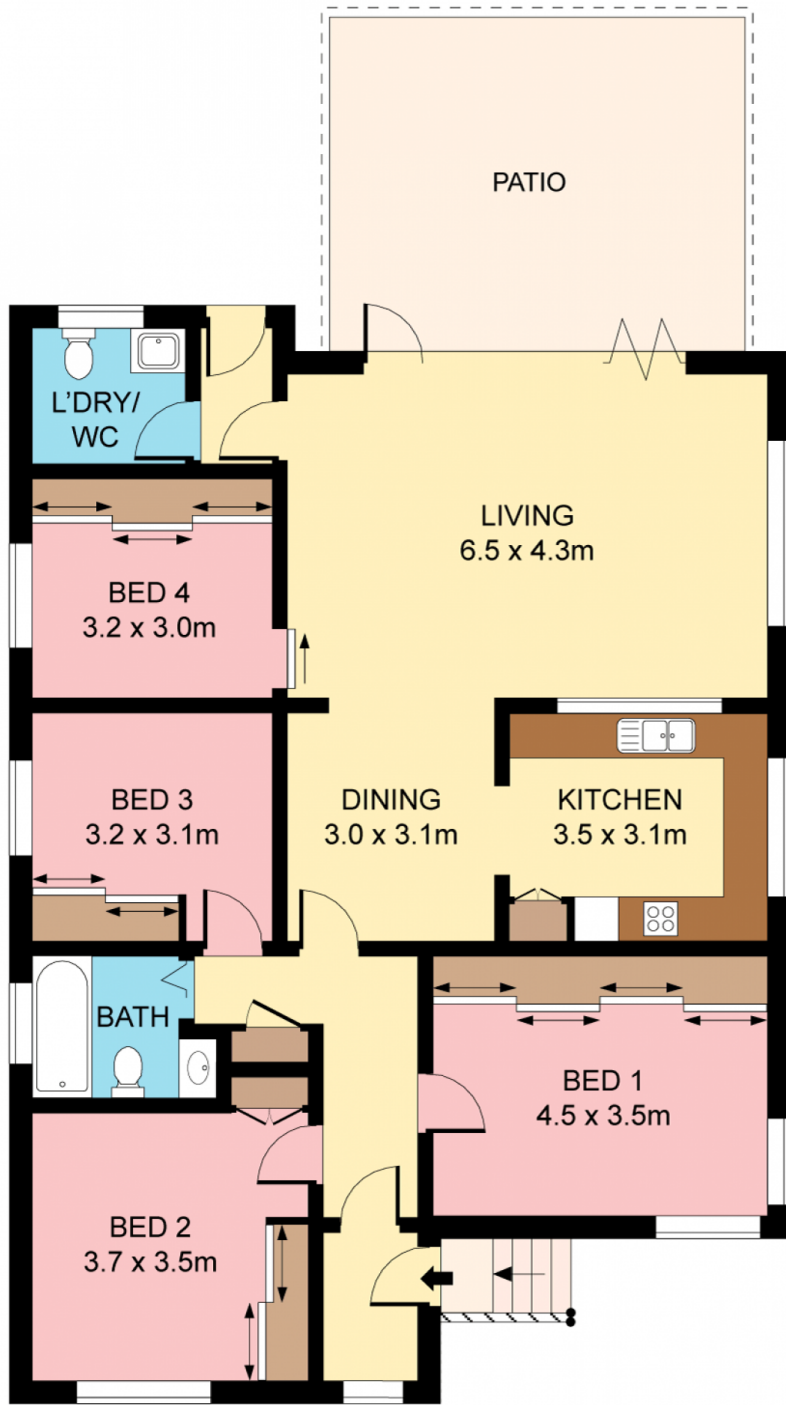

**GROUND FLOOR**

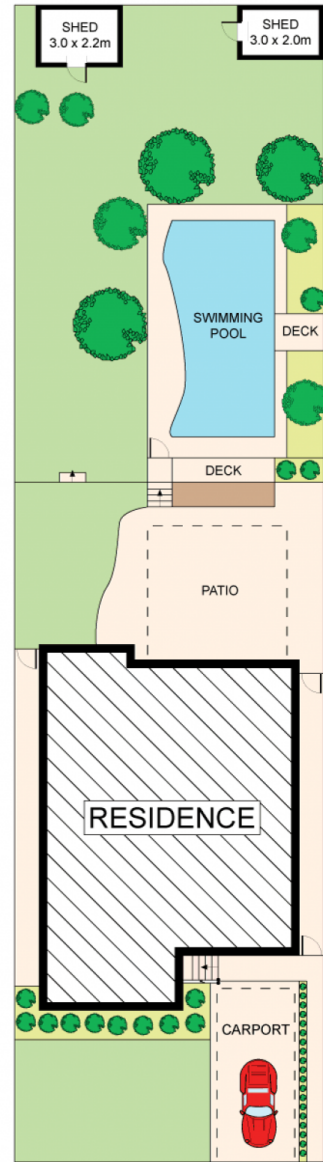

**SITE PLAN  
(NOT TO SCALE)**



Plans shown are for presentation purposes only and are not part of any legal document or title. They are subject to errors, omissions, inaccuracies and should not be used as a sole and accurate reference. Interested parties should make their own inquiries using independent sources.