



**2 Ellesmere Road GYMEA BAY NSW**

4 2 2

Just steps to the waters of Gymea Bay, this updated family home is a tranquil retreat boasting a generous 727.2sqm with north facing, lush leafy outlook and water glimpses from the top deck. Privately set at the end of a cul-de-sac its versatile floor plan spreads across two expansive levels, offering generous accommodation and striking entertaining zones.

Stylishly presented with timber floors and superb in/outdoor flow

Attractive modern kitchen with breakfast bar adjoins large dining

Family living expands onto superb alfresco deck, 2nd deck at front

Lower level features games room plus 2 over-sized beds &

**Type** : House  
**Land Size** : 727 sqm  
**View** : <https://www.jreproperty.com.au/sale/nsw/sutherlandland/gymea-bay/residential/house/7488335>



**Luke Jeffree**  
02 9540 2222

[For full version visit the website](https://www.jreproperty.com.au)

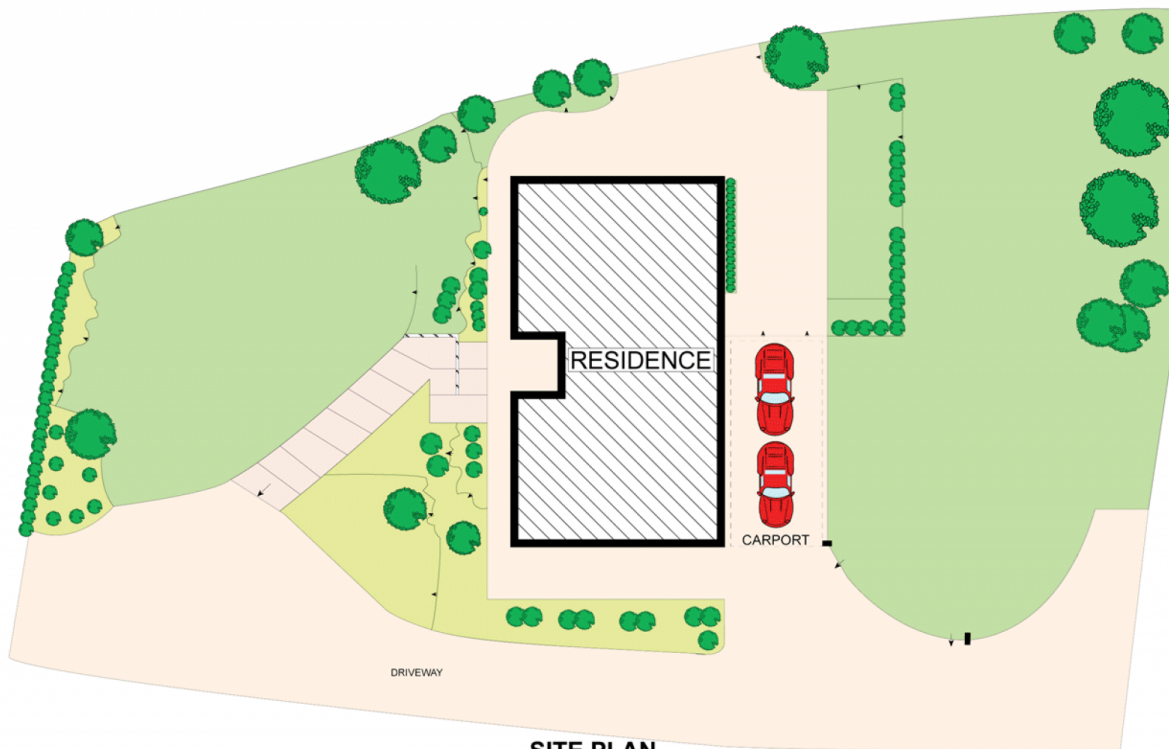

**SITE PLAN  
(NOT TO SCALE)**

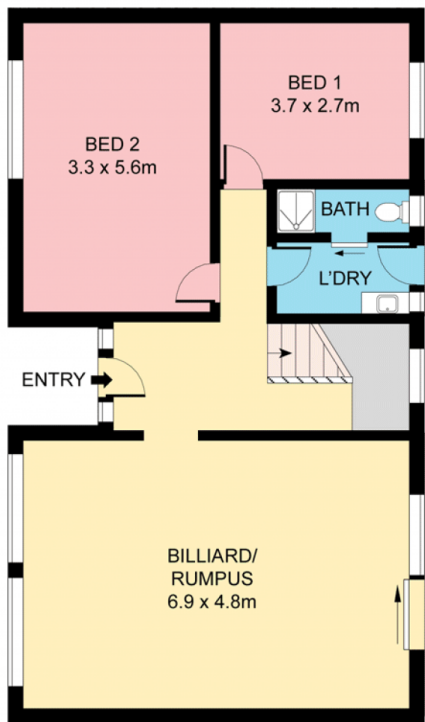

**GROUND FLOOR**



**FIRST FLOOR**



Plans shown are for presentation purposes only and are not part of any legal document or title. They are subject to errors, omissions, inaccuracies and should not be used as a sole and accurate reference. Interested parties should make their own inquiries using independent sources.

**2 ELLESMERE ROAD**

**GYMEA BAY**